



FOR LEASE

# OneAmerica Tower



HOME

HIGHLIGHTS

AVAILABLE

AMENITIES

LOCATION

For more information, please contact:

**Jon R. Owens, SIOR**  
Managing Director  
+1 317 639 0447  
jon.owens@cushwake.com

**Russell VanTil**  
Director  
+1 317 639 0546  
russell.vantil@cushwake.com

[cushmanwakefield.com](http://cushmanwakefield.com)

## Property Highlights

### Summary

Total Building Size: 691,769 SF

Year Built: 1981

Number of Stories: 36

Available Space: 21,328 SF

Avg. Floor Plate (RSF) ±18,000 RSF

Base Rent: \$26.00/SF

Parking: 2.1 per 1,000 RSF

Owner: OneAmerica Financial Partners



For more information, please contact:

**Jon R. Owens, SIOR**  
Managing Director  
+1 317 639 0447  
[jon.owens@cushwake.com](mailto:jon.owens@cushwake.com)

**Russell VanTil**  
Director  
+1 317 639 0546  
[russell.vantil@cushwake.com](mailto:russell.vantil@cushwake.com)

[cushmanwakefield.com](http://cushmanwakefield.com)

## Space Available

Suite Number	Square Footage	Price	Notes
Suite 2675	4,000	\$26.00/sf	Available Immediately
Suite 2700	17,328	\$26.00/sf	Available Immediately

For more information, please contact:

**Jon R. Owens, SIOR**  
Managing Director  
+1 317 639 0447  
[jon.owens@cushwake.com](mailto:jon.owens@cushwake.com)

**Russell VanTil**  
Director  
+1 317 639 0546  
[russell.vantil@cushwake.com](mailto:russell.vantil@cushwake.com)

### OPEN OFFICE CONCEPT

- 12,728 BENCHMARK SQ. FT.
- OPEN OFFICE AREA
- PRIVATE OFFICES (1)
- RECEPTION AREA
- MEETING, CONFERENCE & Huddle (18)
- OPEN MEETING AREA
- Break/Coffee Area
- MAIL/COPIER/STORAGE AREA
- POPULATION COUNT: 128

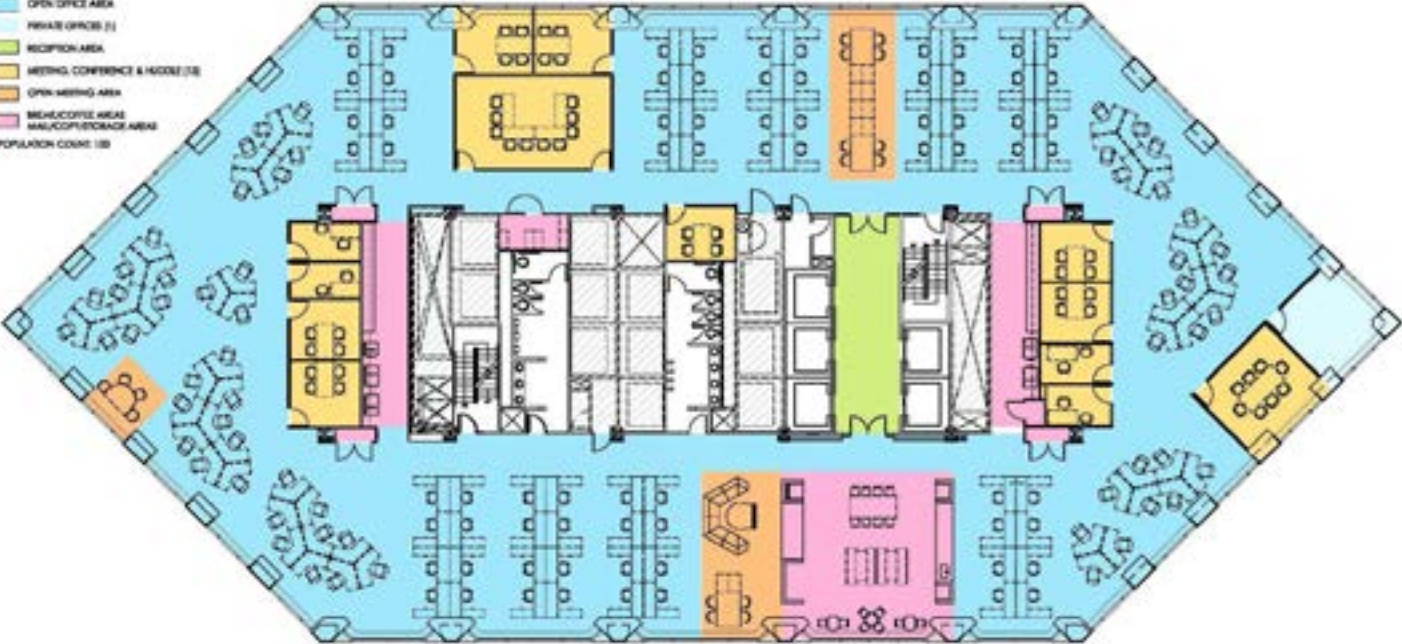

For more information, please contact:

**Jon R. Owens, SIOR**  
Managing Director  
+1 317 639 0447  
jon.owens@cushwake.com

**Russell VanTil**  
Director  
+1 317 639 0546  
russell.vantil@cushwake.com

### PRIVATE OFFICE CONCEPT

- 1,278 RENTABLE SQ. FT.
- OPEN OFFICE AREA
- PRIVATE OFFICE (PI)
- RECEPTION AREA
- MEETING, CONFERENCE & HUBS (MC)
- RECEPTION AREAS  
MAIL/COMPUTER STORAGE AREAS
- POPULATION COUNT: 24

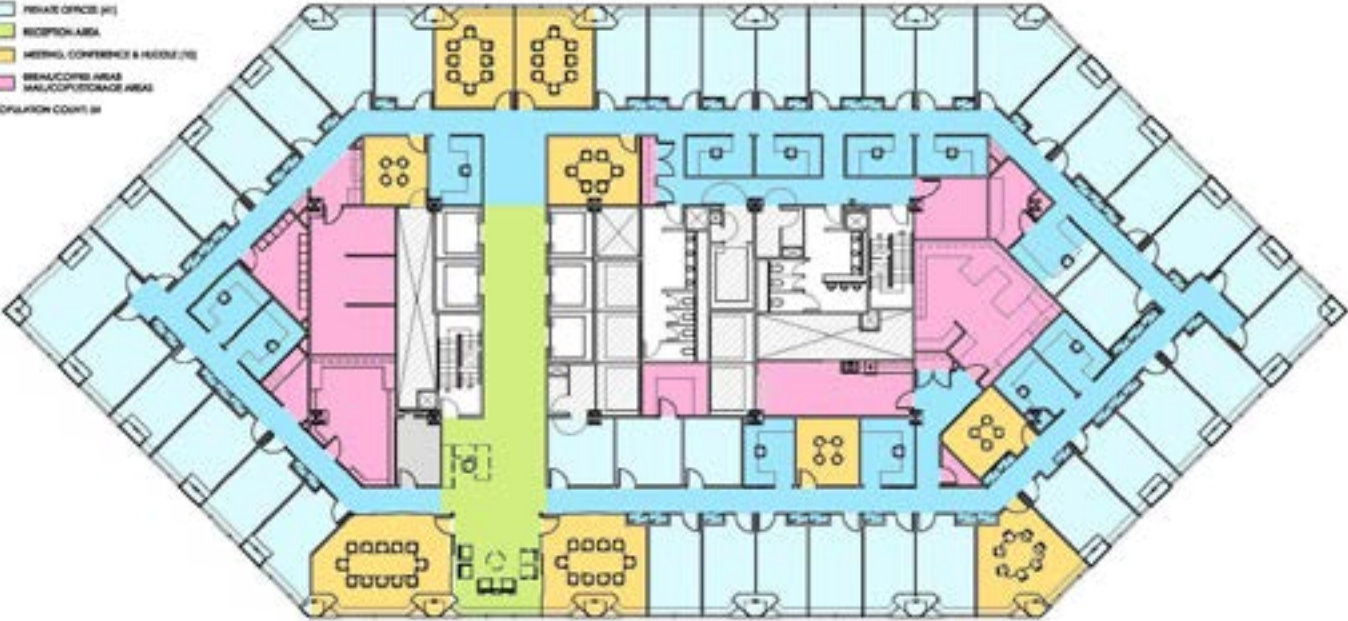

For more information, please contact:

**Jon R. Owens, SIOR**  
Managing Director  
+1 317 639 0447  
jon.owens@cushwake.com

**Russell VanTil**  
Director  
+1 317 639 0546  
russell.vantil@cushwake.com

### PRIVATE & OPEN OFFICE CONCEPT

- 1,178 SQUARE FEET
- OPEN OFFICE AREA
- PRIVATE OFFICE (20)
- RECEPTION AREA
- MEETING, CONFERENCE & HUB (12)
- OPEN MEETING AREA
- BRAND/COFFEE AREA
- MAIL/COPIER/STORAGE AREA
- POPULATION COUNT: 48

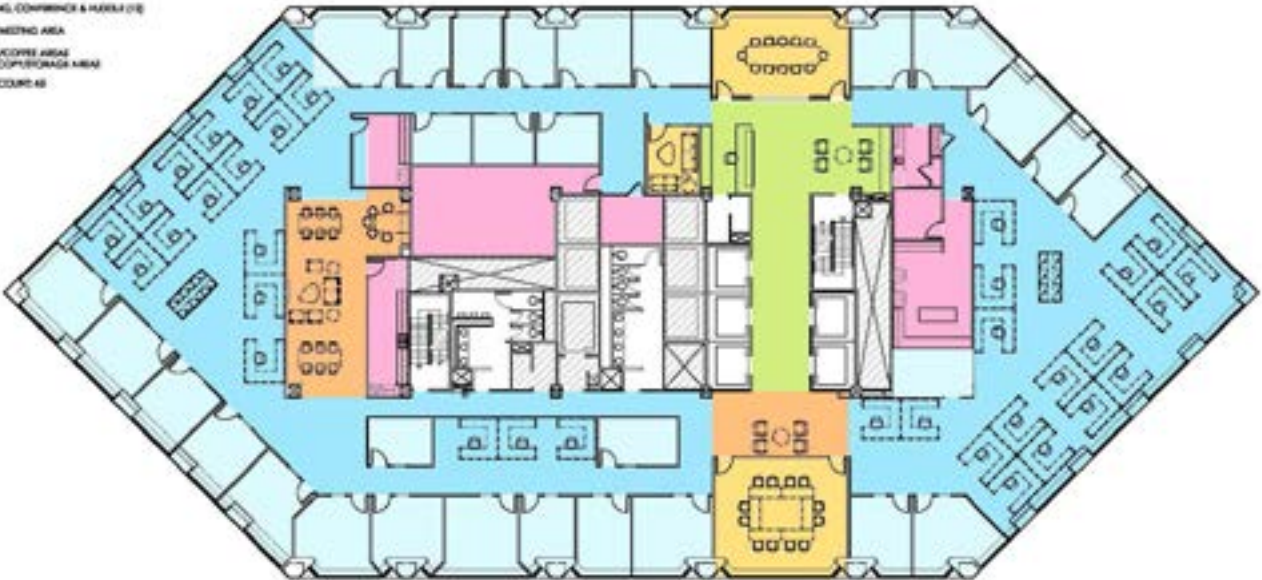

For more information, please contact:

**Jon R. Owens, SIOR**  
Managing Director  
+1 317 639 0447  
jon.owens@cushwake.com

**Russell VanTil**  
Director  
+1 317 639 0546  
russell.vantil@cushwake.com

## Tower Amenities

- Abundant Parking Options
  - Underground Parking
  - Attached Garage
  - Adjacent Parking Lots
- Unique, Urban Courtyard
- Newly Renovated Lobby
- Skyline Club
- Fitness Facility
- Cafeteria Services by Sahn's
- On-Site Catering
- On-Site Management
- Pacers Bikeshare Station
- Dr. Erotas, DDS
- Conference Center
- National Bank of Indianapolis
- Concierge
- Coffee Shop
- Gift Shop
- Shoe Care
- 24/7/365 Security
- 24/7/365 Maintenance
- Dry Cleaning Service

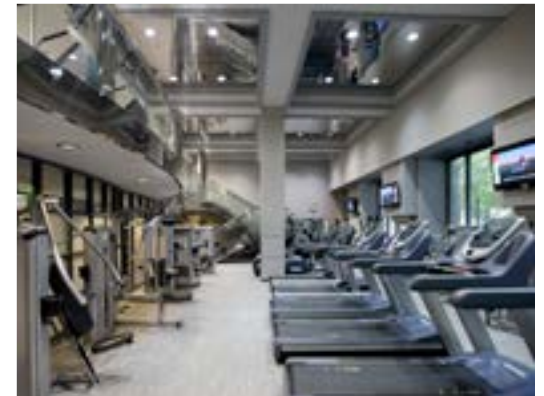

For more information, please contact:

**Jon R. Owens, SIOR**  
Managing Director  
+1 317 639 0447  
jon.owens@cushwake.com

**Russell VanTil**  
Director  
+1 317 639 0546  
russell.vantil@cushwake.com

# OneAmerica Tower



HOME

HIGHLIGHTS

AVAILABLE

AMENITIES

LOCATION

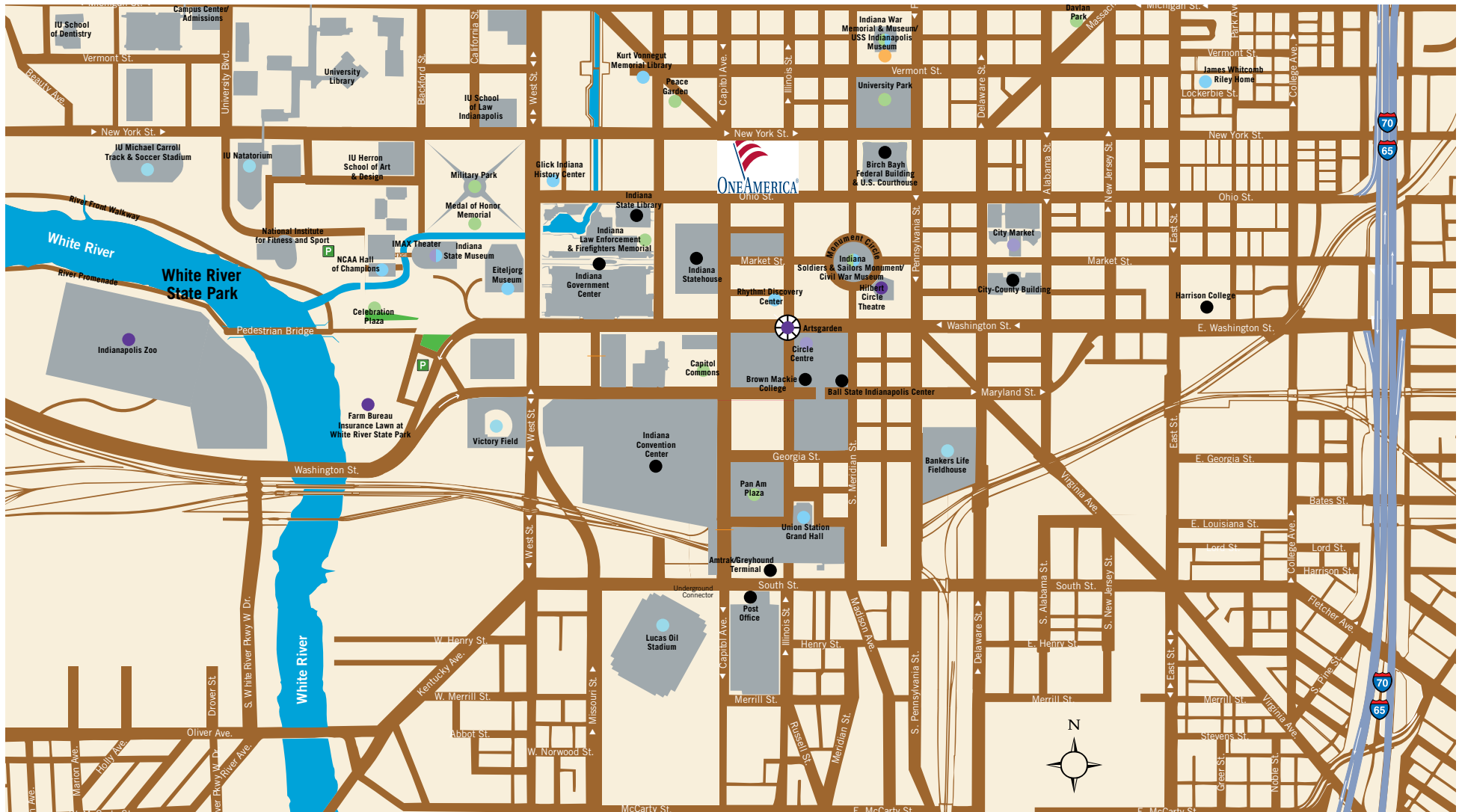

For more information, please contact:

**Jon R. Owens, SIOR**  
Managing Director  
+1 317 639 0447  
jon.owens@cushwake.com

**Russell VanTil**  
Director  
+1 317 639 0546  
russell.vantil@cushwake.com

cushmanwakefield.com



# OneAmerica Tower



HOME

HIGHLIGHTS

AVAILABLE

AMENITIES

LOCATION



For more information, please contact:

**Jon R. Owens, SIOR**  
Managing Director  
+1 317 639 0447  
[jon.owens@cushwake.com](mailto:jon.owens@cushwake.com)

**Russell VanTil**  
Director  
+1 317 639 0546  
[russell.vantil@cushwake.com](mailto:russell.vantil@cushwake.com)

[cushmanwakefield.com](http://cushmanwakefield.com)