



FOR LEASE

OneAmerica Tower



HOME

HIGHLIGHTS

AVAILABLE

AMENITIES

LOCATION

For more information, please contact:

Jon R. Owens, SIOR
Managing Director
+1 317 639 0447
jon.owens@cushwake.com

Russell VanTil
Vice President
+1 317 639 0546
russell.vantil@cushwake.com

cushmanwakefield.com

Property Highlights

Summary

Total Building Size: 691,769 SF

Year Built: 1981

Number of Stories: 36

Available Space: Up to 130,000 SF

Max Contiguous: 130,000 SF

Avg. Floor Plate (RSF) ±18,000 RSF

Base Rent: \$24.50/SF

Parking: 2.1 per 1,000 RSF

Owner: OneAmerica Financial Partners



For more information, please contact:

Jon R. Owens, SIOR
Managing Director
+1 317 639 0447
jon.owens@cushwake.com

Russell VanTil
Vice President
+1 317 639 0546
russell.vantil@cushwake.com

cushmanwakefield.com

Space Available

Suite Number	Square Footage	Price	Notes
Suite 1600	±18,000	\$24.50/sf	Available Immediately
Suite 1700	±18,000	\$24.50/sf	Available Immediately
Suite 1800	±18,000	\$24.50/sf	Available 11/01/16
Suite 1900	±18,000	\$24.50/sf	Available Immediately
Suite 2000	±18,000	\$24.50/sf	Available Immediately
Suite 2100	±18,000	\$24.50/sf	Available Immediately
Suite 2200	±18,000	\$24.50/sf	Available Immediately

For more information, please contact:

Jon R. Owens, SIOR
Managing Director
+1 317 639 0447
jon.owens@cushwake.com

Russell VanTil
Vice President
+1 317 639 0546
russell.vantil@cushwake.com

OPEN OFFICE CONCEPT

17,755 RENTABLE SQ. FT.

- OPEN OFFICE AREA
 - PRIVATE OFFICES (1)
 - RECEPTION AREA
 - MEETING, CONFERENCE & Huddle (13)
 - OPEN MEETING AREA
 - BREAK/COFFEE AREAS
MAIL/COPY/STORAGE AREAS
- POPULATION COUNT: 133

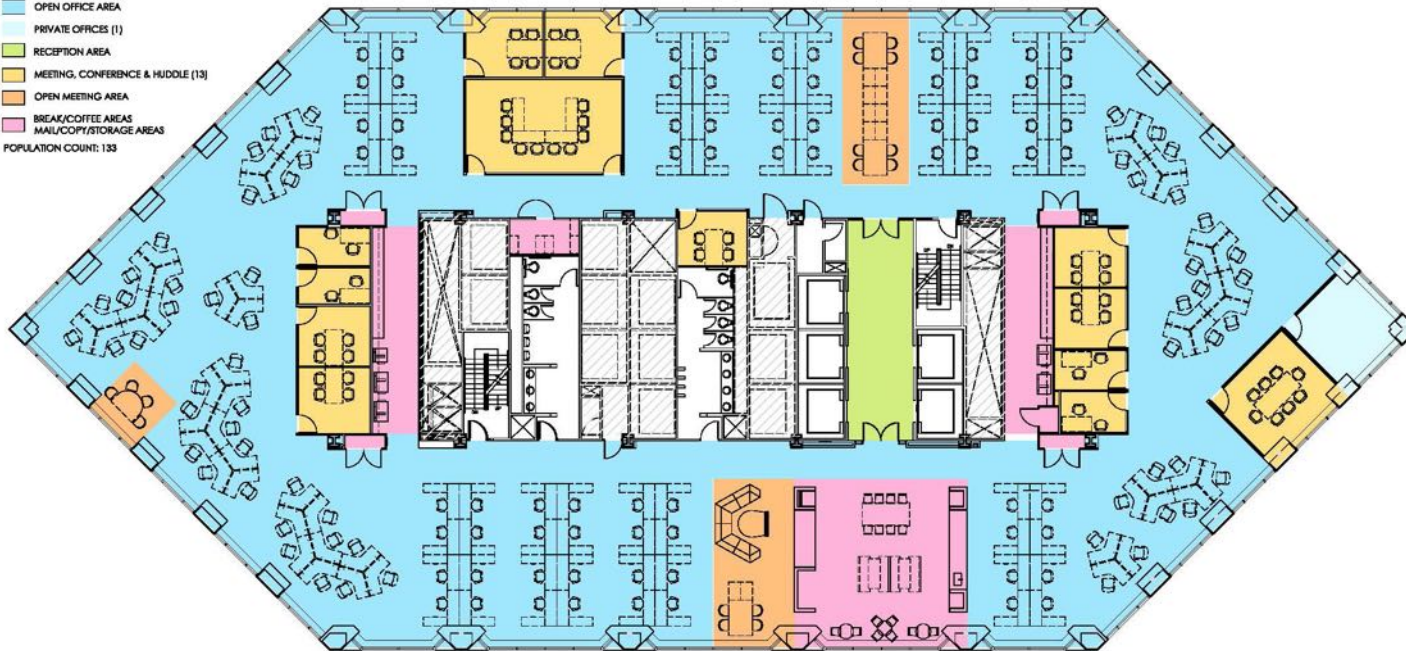

For more information, please contact:

Jon R. Owens, SIOR
Managing Director
+1 317 639 0447
jon.owens@cushwake.com

Russell VanTil
Vice President
+1 317 639 0546
russell.vantil@cushwake.com

cushmanwakefield.com

PRIVATE OFFICE CONCEPT

17,785 RENTABLE SQ. FT.

- OPEN OFFICE AREA
 - PRIVATE OFFICES (41)
 - RECEPTION AREA
 - MEETING, CONFERENCE & Huddle (10)
 - BREAK/COFFEE AREAS
 - MAIL/COPY/STORAGE AREAS
- POPULATION COUNT: 54

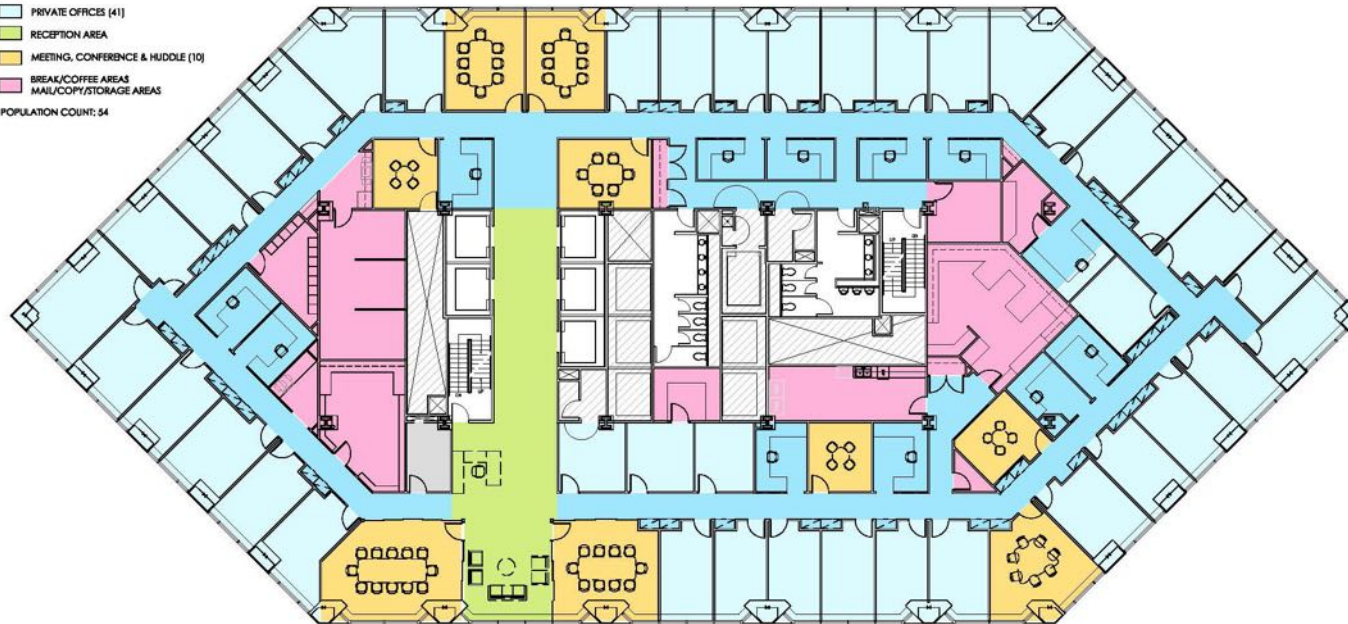

For more information, please contact:

Jon R. Owens, SIOR
Managing Director
+1 317 639 0447
jon.owens@cushwake.com

Russell VanTil
Vice President
+1 317 639 0546
russell.vantil@cushwake.com

cushmanwakefield.com

PRIVATE & OPEN OFFICE CONCEPT

17,755 RENTABLE SQ. FT.

- OPEN OFFICE AREA
 - PRIVATE OFFICES (30)
 - RECEPTION AREA
 - MEETING, CONFERENCE & Huddle (12)
 - OPEN MEETING AREA
 - BREAK/COFFEE AREAS
 - MAIL/COPY/STORAGE AREAS
- POPULATION COUNT: 65

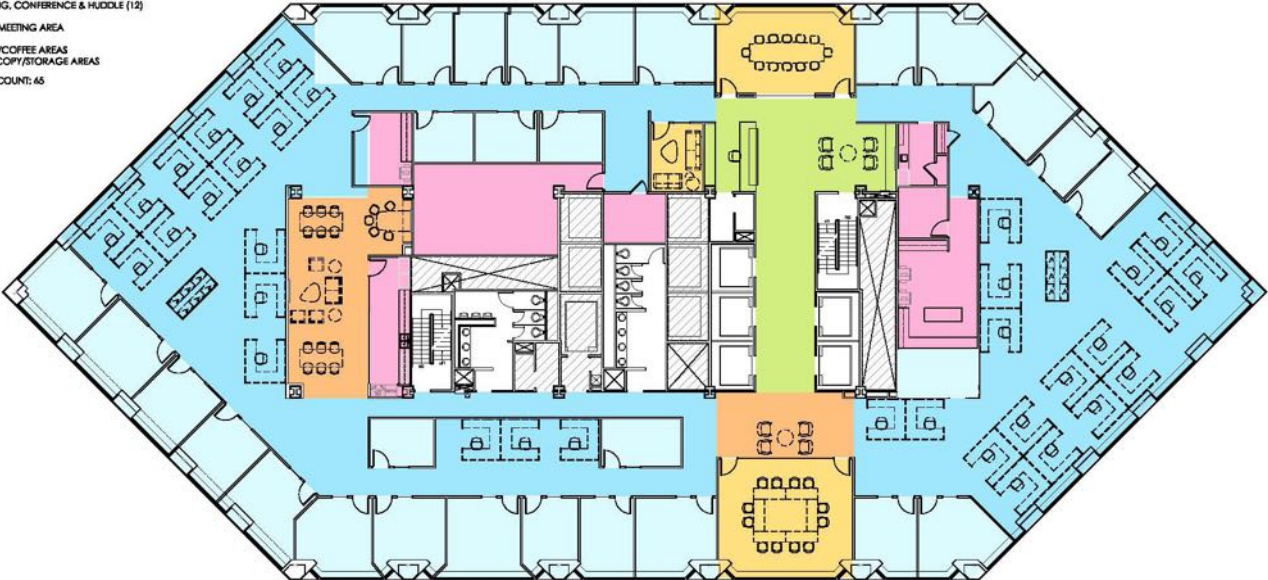

For more information, please contact:

Jon R. Owens, SIOR
Managing Director
+1 317 639 0447
jon.owens@cushwake.com

Russell VanTil
Vice President
+1 317 639 0546
russell.vantil@cushwake.com

Tower Amenities

- Abundant Parking Options
 - Underground Parking
 - Attached Garage
 - Adjacent Parking Lots
- Unique, Urban Courtyard
- Newly Renovated Lobby
- Skyline Club
- Fitness Facility
- Cafeteria Services by Sahm's
- On-Site Catering
- On-Site Management
- Pacers Bikeshare Station
- IU Health Physicians Family Medicine
- Dr. Erotas, DDS
- Conference Center
- National Bank of Indianapolis
- Concierge
- Coffee Shop
- Gift Shop
- Shoe Care
- 24/7/365 Security
- 24/7/365 Maintenance
- Dry Cleaning Service

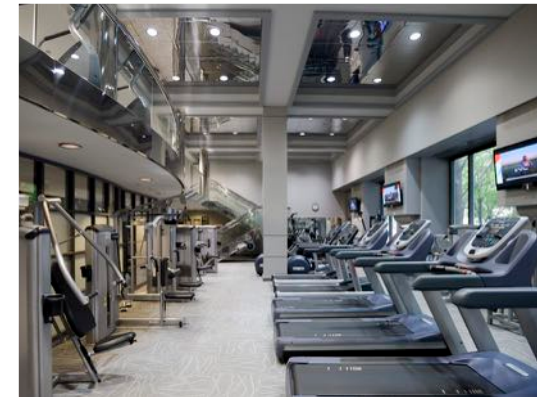

For more information, please contact:

Jon R. Owens, SIOR
Managing Director
+1 317 639 0447
jon.owens@cushwake.com

Russell VanTil
Vice President
+1 317 639 0546
russell.vantil@cushwake.com

OneAmerica Tower



HOME

HIGHLIGHTS

AVAILABLE

AMENITIES

LOCATION

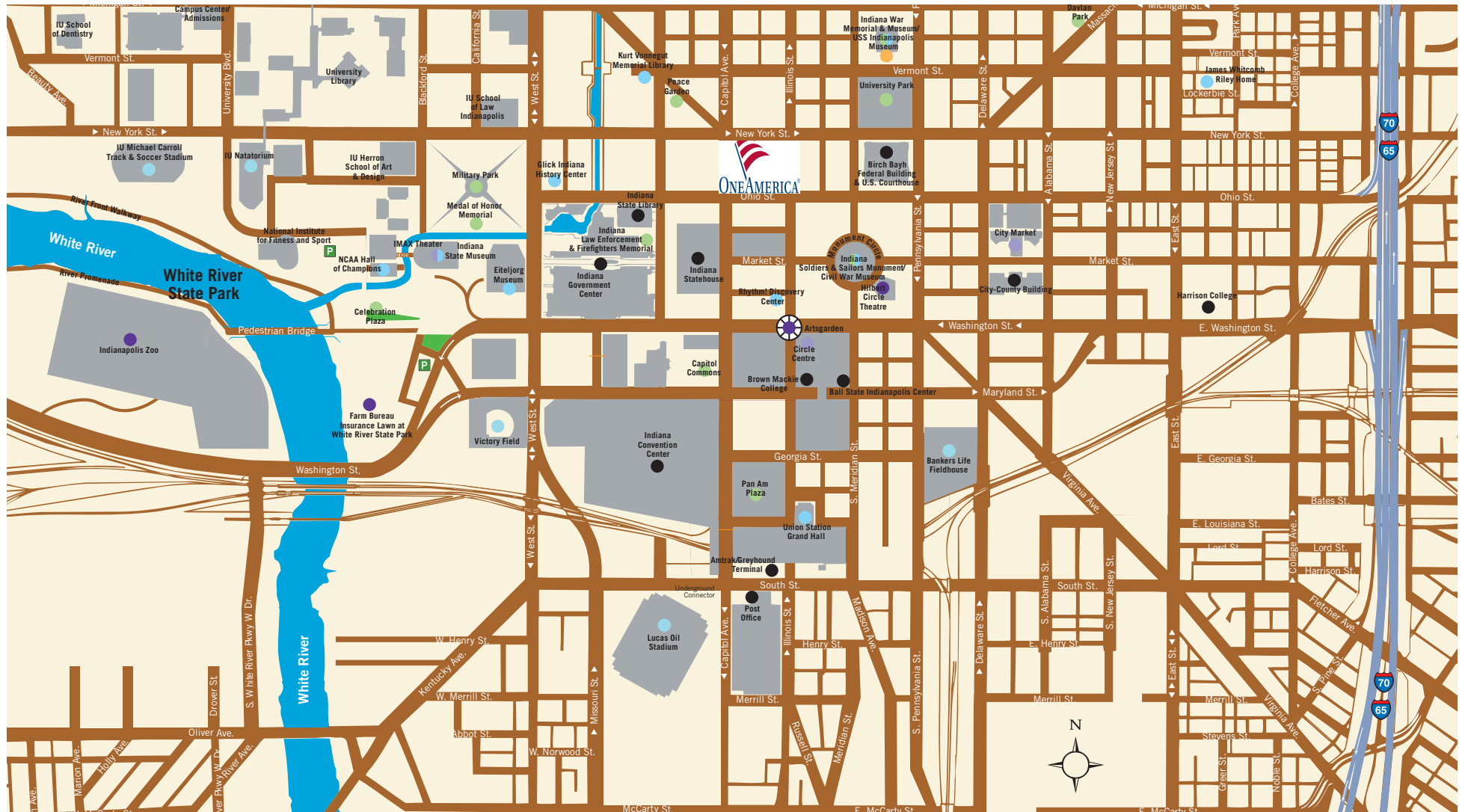

For more information, please contact:

Jon R. Owens, SIOR
Managing Director
+1 317 639 0447
jon.owens@cushwake.com

Russell VanTil
Vice President
+1 317 639 0546
russell.vantil@cushwake.com

cushmanwakefield.com

OneAmerica Tower



HOME

HIGHLIGHTS

AVAILABLE

AMENITIES

LOCATION



For more information, please contact:

Jon R. Owens, SIOR
Managing Director
+1 317 639 0447
jon.owens@cushwake.com

Russell VanTil
Vice President
+1 317 639 0546
russell.vantil@cushwake.com

cushmanwakefield.com